

GPS GROUP
Since 1984

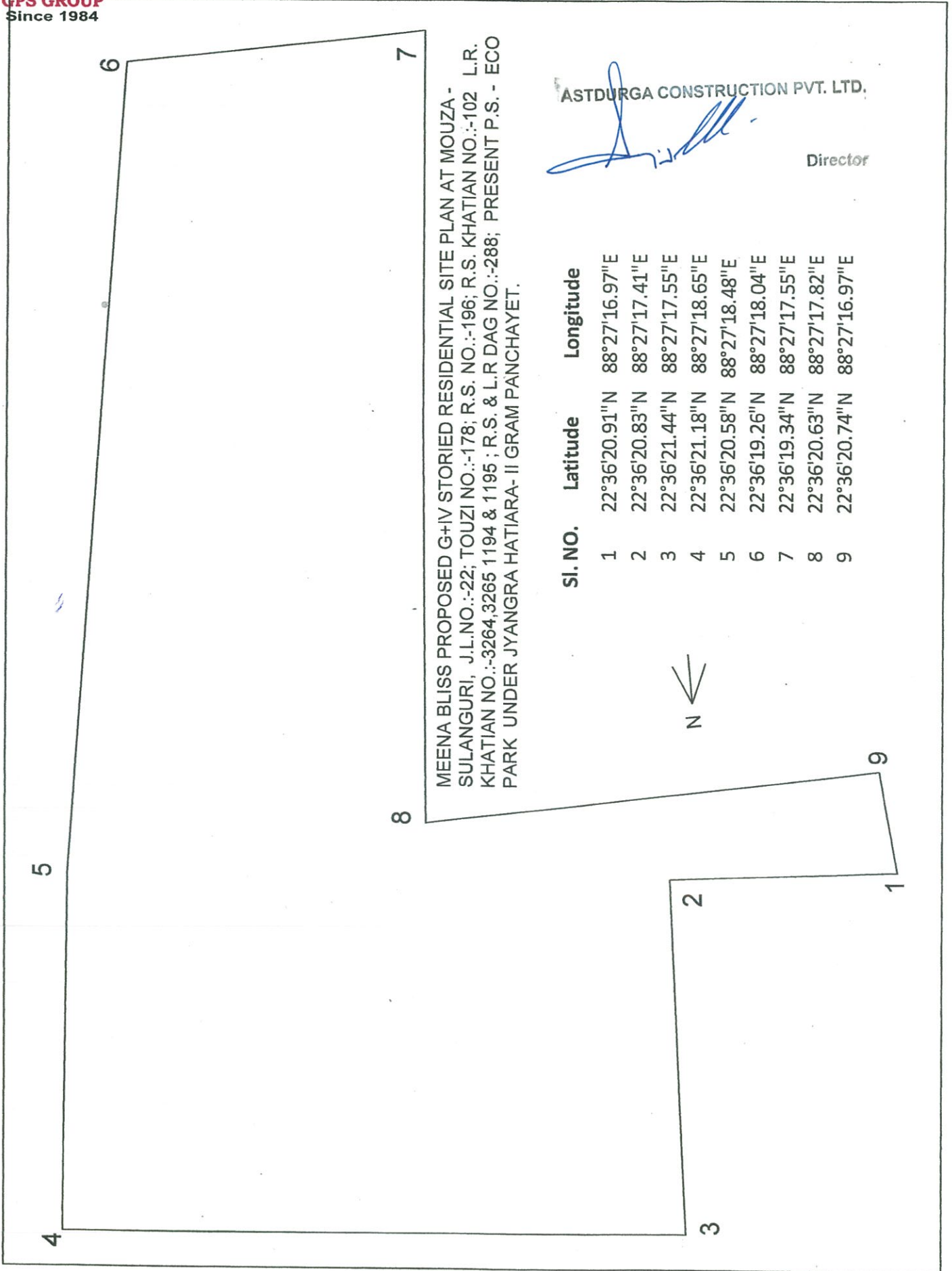

MEENA BLISS PROPOSED G+IV STORIED RESIDENTIAL SITE PLAN AT MOUZA -
SULANGURI, J.L.NO.:-22; TOUZI NO.:-178; R.S. NO.:-196; R.S. KHATIAN NO.:-102 L.R.
KHATIAN NO.:-3264,3265 1194 & 1195 ; R.S. & L.R DAG NO.:-288; PRESENT P.S. - ECO
PARK UNDER JYANGRA HATIARA- II GRAM PANCHAYET.

ASTDURGA CONSTRUCTION PVT. LTD.

Director

Sl. NO.	Latitude	Longitude
1	22°36'20.91"N	88°27'16.97"E
2	22°36'20.83"N	88°27'17.41"E
3	22°36'21.44"N	88°27'17.55"E
4	22°36'21.18"N	88°27'18.65"E
5	22°36'20.58"N	88°27'18.48"E
6	22°36'19.26"N	88°27'18.04"E
7	22°36'19.34"N	88°27'17.55"E
8	22°36'20.63"N	88°27'17.82"E
9	22°36'20.74"N	88°27'16.97"E